

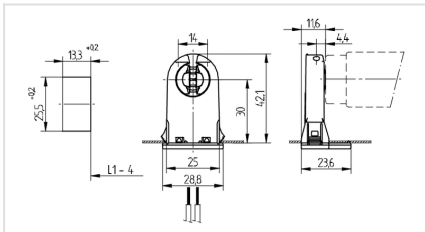

# 26.291.4012

Linear Fluorescent Lampholders: General Applications  
G13 (Medium Bi-Pin): Push-Through Lampholders



**Color:** weiß  
**FC:** 50  
**Part no.:** 26.291.4012.50



18 AWG  
0,5 - 1,0 mm<sup>2</sup>



U out  
500 V



T 130

Tm 110



0,4 - 2,0

## Description

- For enclosed cut-outs
- A pair of lampholders provides a lamp length tolerance compensation of 3 mm

<b>Product name:</b>	Fluorescent lampholder G13
<b>LED type:</b>	G13
<b>Farbe:</b>	white
<b>Mounting method 1:</b>	Push through mount
<b>Material:</b>	Housing: PC Rotor: PBT
<b>Rotor:</b>	with
<b>cULus file no.:</b>	E-92235
<b>Weight:</b>	7
<b>Approval:</b>	cULus
<b>Front Test:</b>	yes
<b>Lamp center:</b>	30
<b>Material thickness:</b>	0.4 - 2.0
<b>T-Marking:</b>	130
<b>Top Test:</b>	yes
<b>Pkg.:</b>	500